

# Land adjacent Kingsfield, Hadrian Way, Baldock

## Site Location Plan

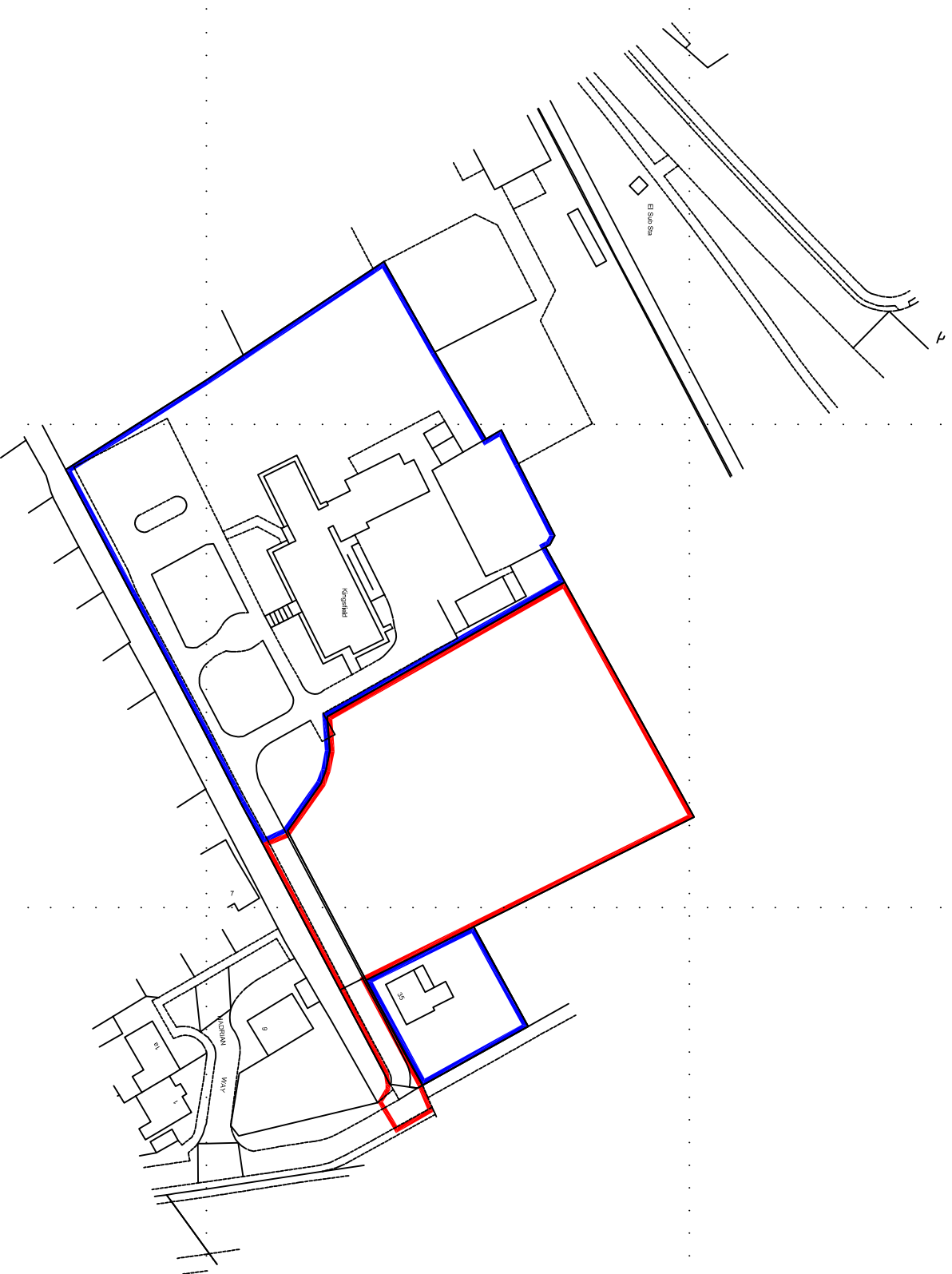

Ordnance Survey (c) Crown Copyright 2017. All rights reserved. Licence number 100022432

Scale 1:1250

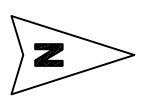
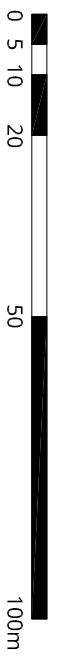

- Application Site
- Other Land in Applicants Ownership

REVISIONS	DATE
A - Amends application site boundary	03/17



Kingsbrook House  
71 Baldock  
Herts SG9 7LW  
T 01234 272829  
M 01234 271412  
F 01234 271412  
info@philipsplanning.co.uk  
**Philips Planning Services Ltd.**  
Town Planning and Development Consultants

**PROJECT**  
Land adjacent to Kingsfield,  
Hadrian Way, Baldock

**TITLE**  
Site Location Plan

**CLIENT**  
Deeside Drylling LTD

SCALE @ A1	DRAWN BY	DATE
1 : 1250	FH	04/17

PROJECT NUMBER	DRAWING NUMBER	REV
164902-1	17-01	-

**GENERAL DISCLAIMER**

Planning drawings only - not to be used for construction purposes. All measurements to be checked on site and any discrepancies to be brought to the attention of the designer

**COPYRIGHT NOTICES**

Copyright © 2017 - All rights reserved. These drawings may not be copied or reproduced in whole or in part without the written consent of Philips Planning Services Ltd.  
Ordnance Survey © Crown Copyright 2017. All rights reserved.  
Licence number 100022432